

TEES

SOCKET FUSION FITTINGS

(SOCKET) IPS & CTS

FOR REFERENCE ONLY

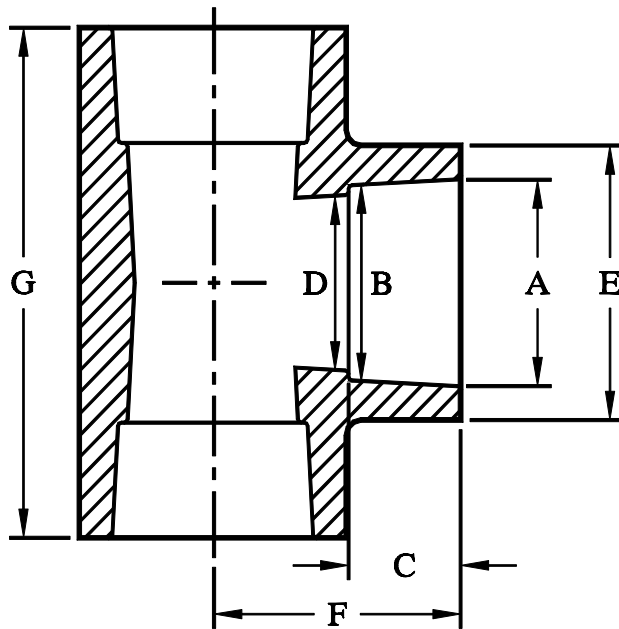

NOMINAL SIZE	A DIAMETER	B DIAMETER	C DEPTH	D I.D.	E O.D.	F LENGTH	G O.A.L.
1/2" CTS	$.585^{+.010}_{-.007}$	$.575^{+.010}_{-.007}$.637	$.524 \pm .015$	$1.177 \pm .032$	1.31	2.63
	14.86 mm	14.61 mm	16.18 mm	13.31 mm	29.90 mm	33.3 mm	66.8 mm
1/2" IPS	$.810^{+.005}_{-.010}$	$.804^{+.005}_{-.026}$.648	$.694 \pm .015$	$1.196 \pm .032$	1.31	2.66
	20.57 mm	20.42 mm	16.46 mm	17.63 mm	30.38 mm	33.3 mm	67.6 mm
3/4" IPS	$1.020 \pm .008$	$1.012^{+.008}_{-.012}$.732	$.870 \pm .015$	$1.493 \pm .032$	1.63	3.25
	25.91 mm	25.70 mm	18.59 mm	22.10 mm	37.92 mm	41.4 mm	82.6 mm
1" CTS	$1.075 \pm .008$	$1.070^{+.008}_{-.012}$.911	$.892 \pm .015$	$1.500 \pm .032$	1.63	3.26
	27.31 mm	27.18 mm	23.14 mm	22.66 mm	38.10 mm	41.4 mm	82.8 mm
1" IPS	$1.275 \pm .008$	$1.267^{+.008}_{-.012}$.755	$1.128 \pm .015$	$1.849 \pm .032$	1.69	3.41
	32.39 mm	32.18 mm	19.18 mm	28.65 mm	46.96 mm	43.0 mm	86.6 mm
1 1/4" IPS	$1.620 \pm .008$	$1.612^{+.008}_{-.016}$.982	$1.452 \pm .015$	$2.300 \pm .032$	2.10	4.22
	41.15 mm	40.94 mm	24.94 mm	36.88 mm	58.42 mm	53.3 mm	107.2 mm
1 1/2" IPS	$1.860 \pm .010$	$1.849^{+.010}_{-.020}$.970	$1.717 \pm .015$	$2.650 \pm .032$	2.34	4.67
	47.24 mm	46.96 mm	24.64 mm	43.61 mm	67.31 mm	59.4 mm	118.6 mm
2" IPS	$2.335 \pm .010$	$2.324^{+.010}_{-.020}$.971	$2.135 \pm .015$	$3.265 \pm .020$	2.78	5.40
	59.31 mm	59.03 mm	24.66 mm	54.23 mm	82.93 mm	70.6 mm	137.2 mm
3" IPS	$3.455 \pm .015$	$3.439^{+.015}_{-.025}$	1.192	$3.212 \pm .130$	$5.250 \pm .130$	4.20	8.28
	87.76 mm	87.35 mm	30.28 mm	81.58 mm	133.35 mm	106.7 mm	210.3 mm
4" IPS	$4.450 \pm .015$	$4.434 \pm .005$	1.334	$4.268 \pm .130$	$6.525 \pm .130$	5.64	11.14
	113.03 mm	112.62 mm	33.88 mm	108.41 mm	165.74 mm	143.3 mm	283.0 mm